

Characteristics and Rating

Characteristics

For renewable application and high altitude

- High breaking capacity (Up to 1000Vac)
- Features compact size
- Various trip unit
- Standards: Acquisition of dual standards IEC/UL



Rating

FRAME		UTV250		
Rated voltage		690/800/1000 Vac		
Rated current		60, 80, 100, 150, 200, 250A		
Number of poles		3/4		
Breaker type		E	N	H
UL489				
Interrupting capacity (kA) UL, CSA	AC 800V	25	42	50
	AC 1000V	14	20	30
IEC 60947-2				
Ultimate breaking capacity (kA), Icu	AC 690V	65	85	100
	AC 800V	25	40	50
	AC 1000V	15	20	30
Service breaking capacity (kA), Ics	AC 690V	65	85	100
	AC 800V	18.5	30	37.5
	AC 1000V	8	10	15
Insulation voltage, Ui		1000 Vac		
Impulse withstand voltage, Uimp		8 kV		
Utilization category		A		
IEC 60947-3				
Insulation voltage, Ui		1000 Vac		
Impulse withstand voltage, Uimp		8 kV		
Rated short-time withstand current, Icw		3 kA		
Utilization category		AC-23A		
Trip Unit				
Trip unit	FTU*	60, 80, 100, 150, 200, 250A		
	FMU*	60, 80, 100, 150, 200, 250A		
	ATU*	100, 150, 200, 250A		
	MCS**	60, 80, 100, 150, 200, 250A		
	DSU***	250A		
Accessories				
Unit mounted		<input type="radio"/>		
Mechanical lugs		<input type="radio"/>		
Busbar connectors		<input type="radio"/>		
Control wire terminal kit		<input type="radio"/>		
Motor operator		<input type="radio"/>		
Interphase barriers		<input type="radio"/>		
Shunt trip		<input type="radio"/>		
Undervoltage trip		<input type="radio"/>		
Auxiliary switch		<input type="radio"/>		
Alarm switch		<input type="radio"/>		
Directly-Mounted rotary operating handle		<input type="radio"/>		
IEC-Door-Mounted operating mechanisms		<input type="radio"/>		
Padlock attachment		<input type="radio"/>		
Weight(approximate), lbs.(kg)	3 Pole	4.85(2.20)		
	4 Pole	6.35(2.88)		
Dimensions, Inches(mm)		W	H	D
	3 Pole	4.13(105)	8.07(205)	3.62(92)
	4 Pole	5.51(140)	8.07(205)	3.62(92)

* FTU, FMU, ATU: UL489, IEC 60947-2 ** UL 489 Only *** IEC 60947-3 Only

Ordering & Temperature derating

MCCB up to 690/800/1000Vac

Ordering

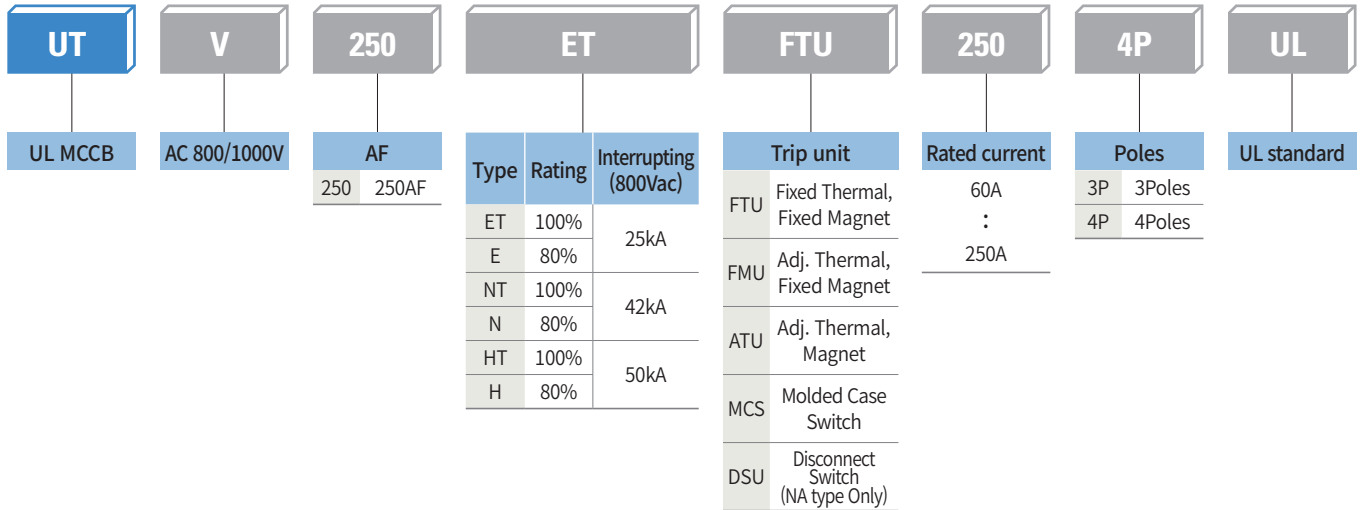

Temperature derating

Type	Rated current (A)	Derating current (A)	Compensated rated current in accordance with ambient temperature (A)																	
			10°C		20°C		30°C		40°C		45°C		50°C		60°C		70°C			
UL489	UTV250	60	60	100%	60	100%	60	100%	60	100%	60	100%	59	98%	57	95%	53	89%	50	83%
		80	80	100%	80	100%	80	100%	80	100%	80	100%	78	98%	76	95%	71	89%	66	83%
		100	100	100%	100	100%	100	100%	100	100%	100	100%	98	98%	95	95%	89	89%	83	83%
		150	150	100%	150	100%	150	100%	150	100%	150	100%	146	97%	141	94%	132	88%	123	82%
		200	200	100%	200	100%	200	100%	200	100%	200	100%	196	98%	190	95%	178	89%	166	83%
		250	250	100%	250	100%	250	100%	250	100%	250	100%	243	97%	235	94%	220	88%	205	82%

Characteristic curve

UTV250 MCCB

FTU
FMU
60~80A

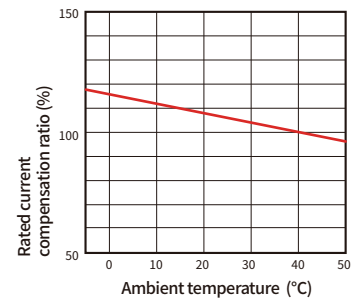
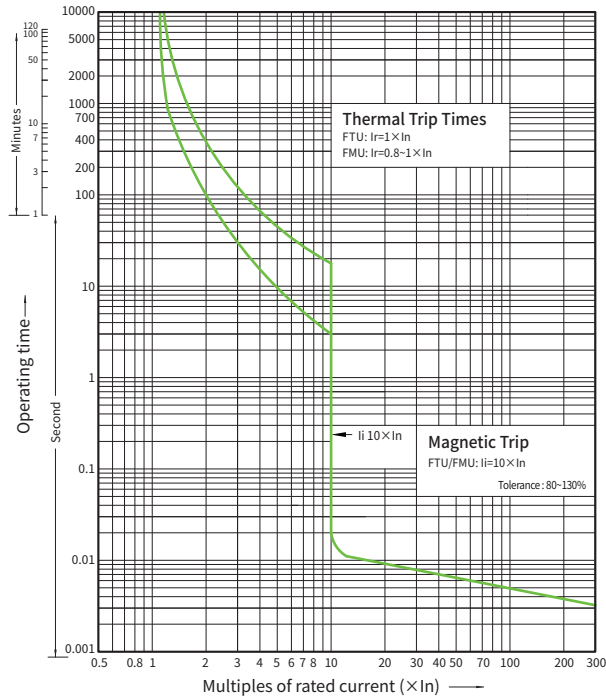

UTV250 MCCB

FTU
FMU
ATU
100~250A

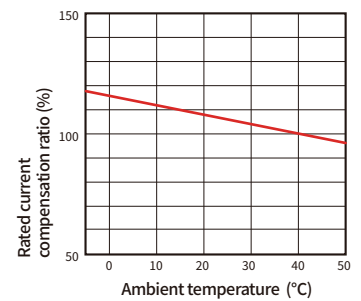
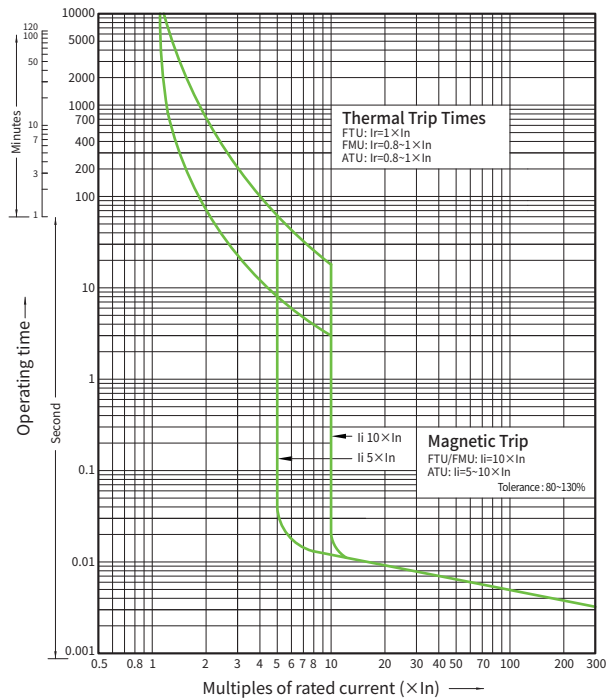

UTV250 MCS

60 ~ 250A

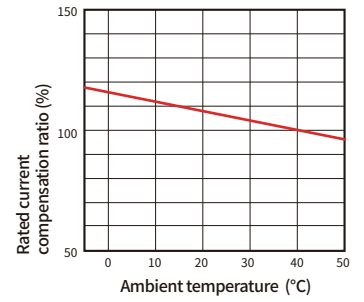
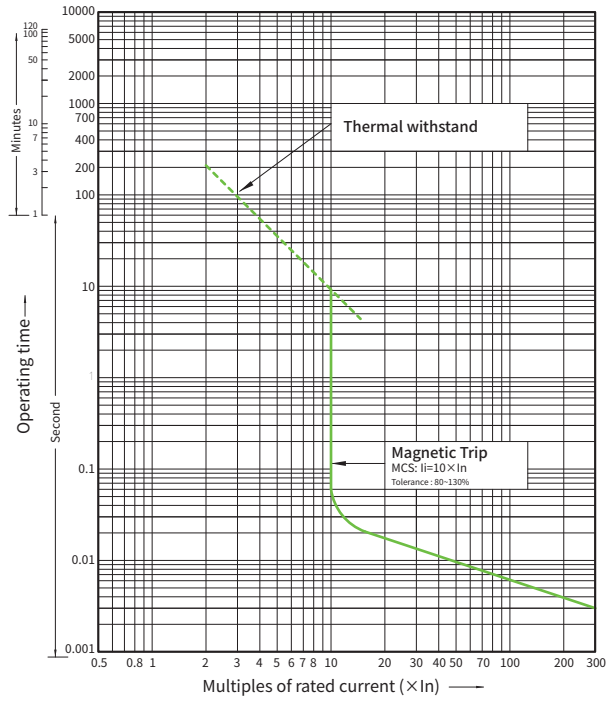

Dimensions

UTV250

[Unit:inch(mm)]

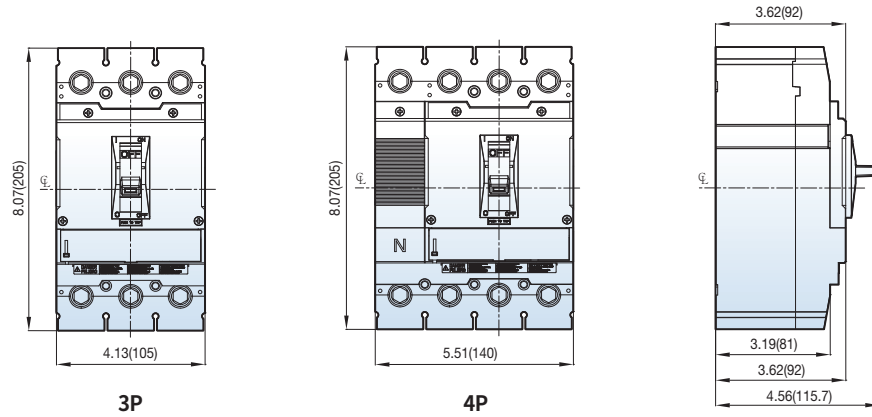

< Panel drilling >

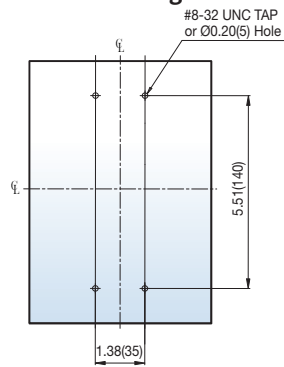

< Front panel cutting >

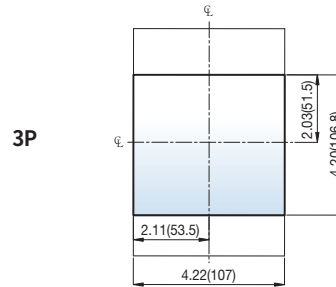

Terminal section

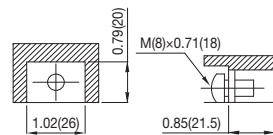

Conductor

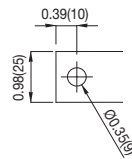

< Panel drilling >

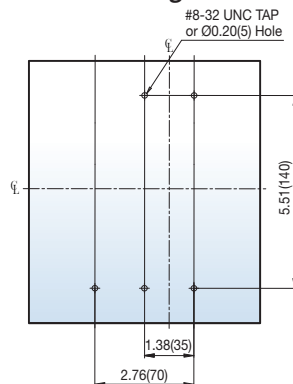

< Front panel cutting >

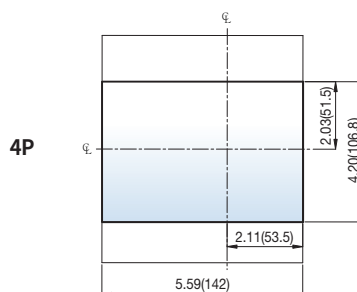

UTV250

[Unit:inch(mm)]

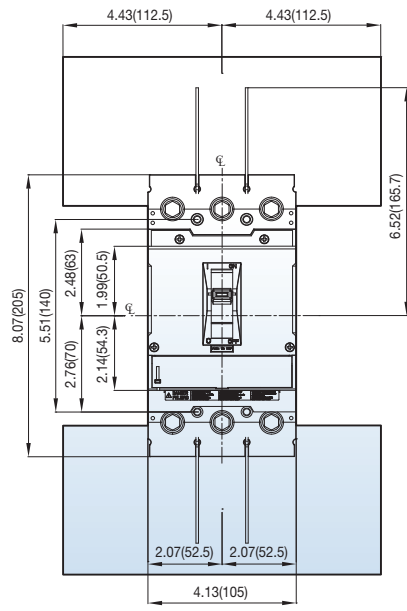

3P

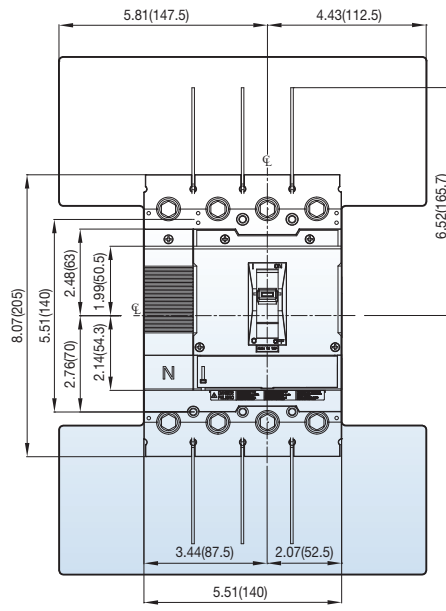

4P

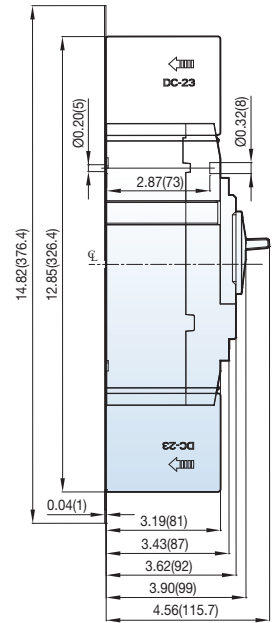



Safety Instructions

- For your safety, please read user's manual thoroughly before operating.
- Contact the nearest authorized service facility for examination, repair, or adjustment.
- Please contact qualified service technician when you need maintenance.
Do not disassemble or repair by yourself!
- Any maintenance and inspection shall be performed by the personnel having expertise concerned.



www.LSElectricAmerica.com

■ LS ELECTRIC America Inc. Chicago Head Office

980 Woodlands Parkway, Vernon Hills, IL 60061 USA
Tel: 1-800-891-2941 E-Mail: sales.us@lselectricamerica.com

■ Headquarter

127 LS-ro (Hogye-dong) Dongan-gu, Anyang-si, Gyeonggi-Do, 14119, Korea

■ Seoul Office

LS Yongsan Tower, 92, Hangang-daero, Yongsan-gu, Seoul, 04386, Korea
Tel: 82-2-2034-4916, 4684, 4429

■ Overseas Subsidiaries

• LS ELECTRIC Japan Co., Ltd. (Tokyo, Japan)

Tel: 81-3-6268-8241 E-Mail: japan@lselectric.com

• LS ELECTRIC (Dalian) Co., Ltd. (Dalian, China)

Tel: 86-411-8730-5872 E-Mail: china.dalian@lselectric.com.cn

• LS ELECTRIC (Wuxi) Co., Ltd. (Wuxi, China)

Tel: 86-510-6851-6666 E-Mail: china.wuxi@lselectric.com.cn

• LS ELECTRIC Vietnam Co., Ltd. (Hanoi, Vietnam)

Tel: 84-222-2221-110 E-Mail: vietnam@lselectric.com

• LS ELECTRIC Middle East FZE (Dubai, U.A.E.)

Tel: 971-4-886-5360 E-Mail: middleeast@lselectric.com

• LS ELECTRIC Europe B.V. (Hoofddorp, Netherlands)

Tel: 31-20-654-1424 E-Mail: europartner@lselectric.com

• LS ENERGY SOLUTIONS LLC (Charlotte, USA)

Tel: 1-704-587-4051 E-Mail: cmfeldman@ls-es.com

• LS ELECTRIC Türkiye Co., Ltd. (Istanbul, Türkiye)

Tel: 90-212-806-1252 E-Mail: turkiye@lselectric.com

• LS ELECTRIC IBERIA S.L.U. (Madrid, Spain)

Tel: 34-910-28-02-74 E-Mail: iberia@lselectric.com

■ Overseas Branches

• LS ELECTRIC Tokyo Office (Japan)

Tel: 81-3-6268-8241 E-Mail: tokyo@lselectric.com

• LS ELECTRIC Beijing Office (China)

Tel: 86-10-5095-1631 E-Mail: china@lselectric.com.cn

• LS ELECTRIC Shanghai Office (China)

Tel: 86-21-5237-9977 E-Mail: china@lselectric.com.cn

• LS ELECTRIC Guangzhou Office (China)

Tel: 86-20-3818-2883 E-Mail: china@lselectric.com.cn

• LS ELECTRIC Chengdu Office (China)

Tel: 86-28-8670-3201 E-Mail: china@lselectric.com.cn

• LS ELECTRIC Qingdao Office (China)

Tel: 86-532-8501-2065 E-Mail: china@lselectric.com.cn

• LS ELECTRIC Nanjing Office (China)

Tel: 86-25-8467-0005 E-Mail: china@lselectric.com.cn

• LS ELECTRIC Bangkok Office (Thailand)

Tel: 66-90-950-9683 E-Mail: thailand@lselectric.com

• LS ELECTRIC Jakarta Office (Indonesia)

Tel: 62-21-2933-7614 E-Mail: indonesia@lselectric.com

• LS ELECTRIC Moscow Office (Russia)

Tel: 7-499-682-6130 E-Mail: info@lselectric-ru.com

• LS ELECTRIC America Western Office (Irvine, USA)

Tel: 1-949-333-3140 E-Mail: america@lselectric.com

• LS ELECTRIC India Office (India)

Tel: 91-80-6142-9108 E-Mail: info_india@lselectric.com

• LS ELECTRIC Singapore Office (Singapore)

Tel: 65-6958-8162 E-Mail: singapore@lselectric.com

• LS ELECTRIC Italy Office (Italy)

Tel: 39-030-8081-833 E-Mail: italia@lselectric.com